

SERIES 6000M
FITTINGS AND ACCESSORIES
FOR MISTING SYSTEMS



SERIES 6000M MISTING SYSTEMS



The range of Series 6000M fittings has been designed for misting systems. Thanks to its very robust design, it guarantees a tight connection even at very high pressures. The versatility of these fittings and their easy installation allow them to be used in a large number of applications, for example for cooling in both indoor and outdoor environments, dust removal and in a wide variety of industrial and agricultural production processes. The misting fittings are based on an innovative design that allows them to be used in a range of applications, while reducing costs and waste.

BENEFITS



Reliable tightening



Robust design



High pressure



Compact design



Designed for numerous applications



Indoor / Outdoor cooling



Humidity management (humidification)



Fire protection



Dust suppression



Odour control



Mosquito and insect control



Irrigation



Series 6000M fittings for misting systems

External tube diameters:
1/4, 3/8, 1/2 inch

Fitting threads:
1/4, 3/8, 1/2 NPTF; 12/24 UNC; 10/24 UNC; 9/16-24 UNEF



Series 6000M fittings have been designed and produced to meet the specific requirements of the misting sector. This new range takes origin from the already existing Series 6000, which has been changed and enriched with new accessories.

The push-in fittings system ensures maximum tightening even at very high working pressures.

General data

Materials	body and collet: nickel-plated brass O-ring: NBR
Threads	1/4, 3/8, 1/2 NPTF; 12/24 UNC; 10/24 UNC; 9/16-24 UNEF
Pressure	-0.9 bar ÷ 80 bar (see the tubes)
Connection tube	Rilsan® polyamide 11 (PA11) polyamide 12 (PA12) metal tubes (for further details please contact our technicians)
Diameters	1/4" (Ø 6,35), 3/8" (Ø 9,53), 1/2" (Ø 12,7)
Medium	water and compressed air (for other kinds of fluids please contact our technicians)
Temperature	-20°C ÷ 80°C (see the characteristics of the tubes used)

Installation procedures

Connection of the tube

- 1. Cut** the tube perpendicularly to its axis.
We recommend to use Camozzi tube cutters Mod. PNZ-12 or PNPZ-12.



WARNING

The tube should be clean and free from chips, cuts, scratches or any other damage before it is inserted into the connector.



- 2. Insert** the tube into the connector.
Push it to the bottom of the internal surface of the connector.



WARNING

Ensure the tube is pushed up to the bottom of the connector.



- 3. Disconnect** the tube.
Pull the collet towards the connector as shown by the arrows (Pic. 1), then the tube can be disconnected (Pic. 2).
If you have difficulty, you can use the tube disconnecting set Mod. SP.



WARNING

Ensure the system is decompressed before disconnecting the tube from the connector.

Pic. 1



Pic. 2



Fittings Mod. M6540

Union Tee

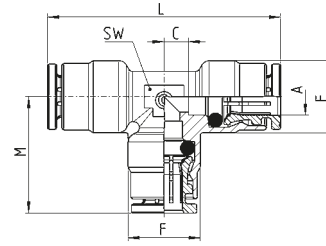

DIMENSIONS							
Mod.	A	C	F	L	M	SW	Weight (g)
M6540 04-00	1/4	4	12.7	40	20	9	23
M6540 06-00	3/8	6	16.5	53	26	13	48
M6540 08-00	1/2	7.1	19.5	53	26.5	15	54

Fittings Mod. M6550

Union Elbow

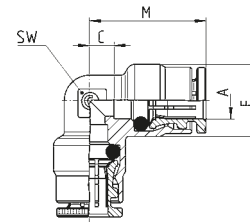

DIMENSIONS						
Mod.	A	C	F	M	SW	Weight (g)
M6550 04-00	1/4	4	12.7	20	9	16
M6550 06-00	3/8	6	16.5	26	13	35
M6550 08-00	1/2	7.1	19.5	26.5	15	40

Fittings Mod. M6580

Union Straight

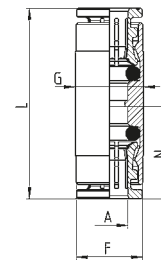

DIMENSIONS						
Mod.	A	F	G	L	N	Weight (g)
M6580 04-00	1/4	12.7	12	33.5	16.2	15
M6580 06-00	3/8	15.4	17	41	20	38
M6580 08-00	1/2	18.3	19	39.5	19.2	36

Fittings Mod. M6510



NPTF Male Straight

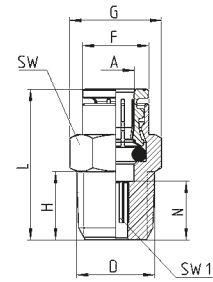

DIMENSIONS										
Mod.	A	D	C	F	G	H	L	SW	SW1	Weight (g)
M6510 04-04	1/4	1/4 NPTF	10.3	11.7	16	12	26.5	14	4	19
M6510 04-06	1/4	3/8 NPTF	10.8	11.7	22	12	27	19	4	36
M6510 06-06	3/8	3/8 NPTF	9	15.4	22	12	29	19	7	34
M6510 06-08	3/8	1/2 NPTF	9.5	15.4	25.5	15.5	29.5	22	7	50
M6510 08-08	1/2	1/2 NPTF	10.8	18.3	25.5	15.5	30	22	10	44

Fittings Mod. M6103



45° Elbow Adaptor

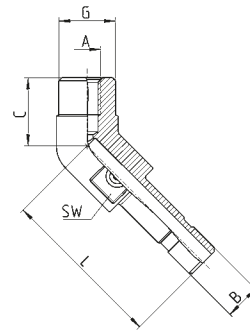

DIMENSIONS							
Mod.	A	B	C	G	L	SW	Weight (g)
M6103 04-32-S02	10/24 UNC	1/4	12	10	29	11	13

Fittings Mod. M6953



Straight Adaptor

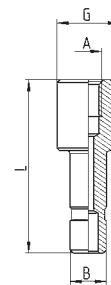

DIMENSIONS					
Mod.	A	B	G	L	Weight (g)
M6953 04-32-S02	10/24 UNC	1/4	11	30.5	19

Fittings Mod. M6580 06...S0...



Union Straight with hole for nozzle

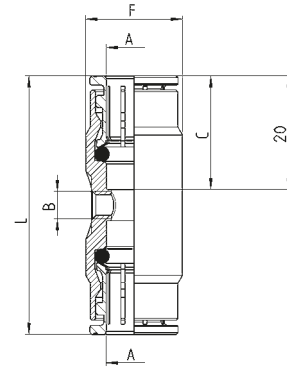

DIMENSIONS						
Mod.	A	B	C	F	L	Weight (g)
M6580 06-00-S01	3/8	10/24 UNC	20	17	45.5	43
M6580 06-00-S02	3/8	10/24 UNC	20	17	45.5	44

Fittings Mod. M6540 04...S01



Union Tee Adaptor

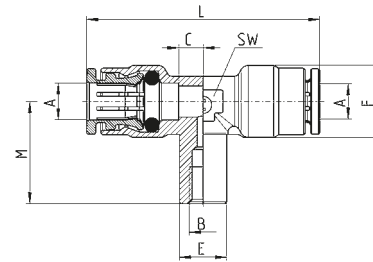

DIMENSIONS								
Mod.	A	B	C	E	F	M	L	Weight (g)
M6540 04-10/24-UNC-S01	1/4	10/24 UNC	4.3	8.3	12.7	18	41	23

Fittings Mod. M6540 04...S02



Union Straight with hole for nozzle

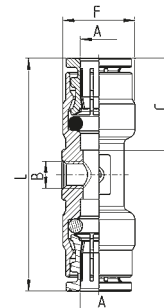

DIMENSIONS						
Mod.	A	B	C	F	L	Weight (g)
M6540 04-10/24-UNC-S02	1/4	10/24 UNC	16.2	12.7	41	18

Fittings Mod. M6900



Male Plug

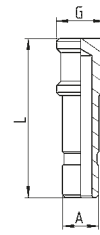

DIMENSIONS				
Mod.	A	L	G	Weight (g)
M6900 04-0T	1/4	28	8.5	6
M6900 06-0T	3/8	33	11.5	10

Fittings Mod. M6750



Female Plug

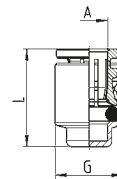

DIMENSIONS				
Mod.	A	G	L	Weight (g)
M6750 04-00	1/4	12	17	6
M6750 06-00	3/8	15.3	21	12
M6750 08-00	1/2	18.2	20	14

Fittings Mod. M6560



Union Y

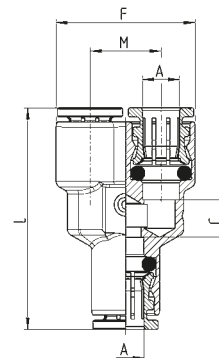

DIMENSIONS						
Mod.	A	C	F	L	M	Weight (g)
M6560 02-00	1/8	5	18	33	9	21
M6560 53-00	5/32	5	18	33	9	18
M6560 04-00	1/4	6.5	24.5	39	12.5	29

Fittings Mod. M2103



45° threaded Elbow

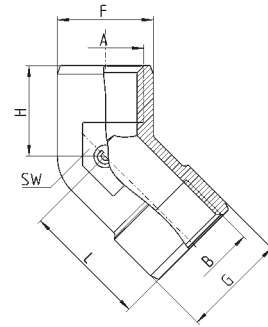

DIMENSIONS

Mod.	A	B	F	G	H	L	SW	Weight (g)
M2103 04-9/16-24-UNEF	1/4 NPTF	9/16-24-UNEF	17	18.5	16	22	17	35

Fittings Mod. M2532



Plug Hole

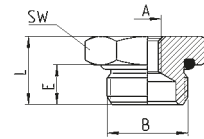

DIMENSIONS

Mod.	A	B	E	L	SW	Weight (g)
M2532 9/16-24-UNEF-10/24-UNC	10/24 UNC	9/16-24 UNEF	7	12	19	16

Fittings Mod. M2033



Female Cross

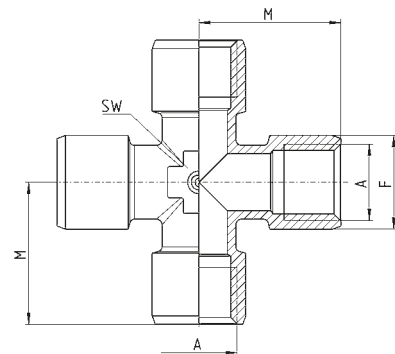

DIMENSIONS

Mod.	A	F	M	SW	Weight (g)
M2033 04-00	1/4 NPTF	16.5	25	14	59
M2033 06-00	3/8 NPTF	20	26.5	16	83

Accessories

Tubes in polyamide PA11 Rilsan® Mod. TRSR

Colour: black



Mod.	D/d	Max pressure at 23°C (bar)	Weight (g/m)	Bend radius (mm)	Lot (m)
TRSR 6,35/3,2	6,35/3,2	87	24.3	40	100

Tubes in polyamide PA12 Mod. TSR

Colour: black



Mod.	D/d	Max pressure at 23°C (bar)	Weight (g/m)	Bend radius (mm)	Lot (m)
TSR 9,53/5	9,53/5	87	54.3	120	100
TSR 12,7/7	12,7/7	87	89	120	100

Tubes cutters Mod. PNZ and PNZP

Replacement blades of Mod. PNZ can be ordered separately
Tubes cutter Mod. PNZP is in plastic



Mod. PNZ



Mod. PNZP

Mod. PNZ-12	able to cut tubes with Ø till to 12 mm
PNZP-12	able to cut tubes with Ø till to 12 mm

Disconnecting tube set Mod. SP

The set includes keys to disconnect tubes with diameters between 5/32" and 1/2".



Mod. SP

Contacts

Camozzi Automation S.p.A.

Società Unipersonale
Via Eritrea, 20/I
25126 Brescia
Italy
Tel. +39 030 37921
info@camozzi.com

Customer Service

Tel. +39 030 3792790
service@camozzi.com

Export Department

Tel. +39 030 3792262
sales@camozzi.com



Automation

